



Cat[®] B Series Breakers

FEATURES & BENEFITS:

High Impact Power

- Outstanding impact power proved in the field.

Superb Productivity

- Optimized tool length and design. High grade steel and heat-treatment provides high output.

Outstanding Field-proven Reliability and Durability

- Breaker design, manufacturing practices, quality inspection and testing of breakers provides durability required for tough applications.
- All breakers are tested in accordance with ISO Quality Control System before delivery.

Multiple Styles



Top-mount



Side-mount

Design for Tough Applications

- Such as quarry, road construction, demolition as well as utility purposes and general construction.

Perfect Match to Cat[®] Machines

- Ensure better breaker performance, enhance efficiency and maximize productivity.
- Mounting brackets and hammer housings are built for Cat linkages.
- Connecting lines to Match Cat implement lines.

Easy Maintenance

- Easy access to tool and bushings provides superior maintenance capability in the field.
- Field replaceable lower tool bushing.
- Full length side plates - easy access to service points

Strong Cat Service Support Network

- Installation and service.
- Parts available from Cat dealers.
- Technical support from Cat dealers.

Cat B Series Breakers

Features & Benefits

1. SIDE ROD NUT

Thread damage controlled by anti-seize greasing application.

2. SIDE ROD (THROUGH BOLT)

Longer life with high quality material and heat-treatment.

3. PRESSURE CHECK POINT

Easy check-up for hammer operating condition.

4. OIL CONTROL VALVE

Outer type for easy setting. Simple and effective valve provides reduced pulsation, and low maintenance cost.

5. MAIN PARTS (Cylinder, Back Head, Front Head, Piston, Tool)

High quality materials and processes used in manufacturing components.

6. BACK HEAD

Bigger N₂ gas chamber. Designed to provide greater power for breaking and absorb piston recoil improving tie rod life.

7. PISTON

Piston provides maximum energy transfer to produce excellent breaking capability. Design and surface finish provides best performance and oil retention resulting in better seal life.

8. STROKE CONTROL VALVE *

BPM (beats per minute) adjuster for primary breaking job / secondary breaking job .

9. ACCUMULATOR*

Standard supply from factory. High pressure accumulator is field serviceable and protects carrier hydraulic circuit by absorbing pulsation spikes created during firing stroke.

10. HOUSING

Reinforcement plates at bottom. Protects against breakage and wear. B20 model offers side-mount & top-mount two styles.

11. TOOLS

Heat treated for longer life. Optimum length for effective breaking.

*Not Applicable for B8

12. Top-Mount/Side-Mount Style for B20/B30

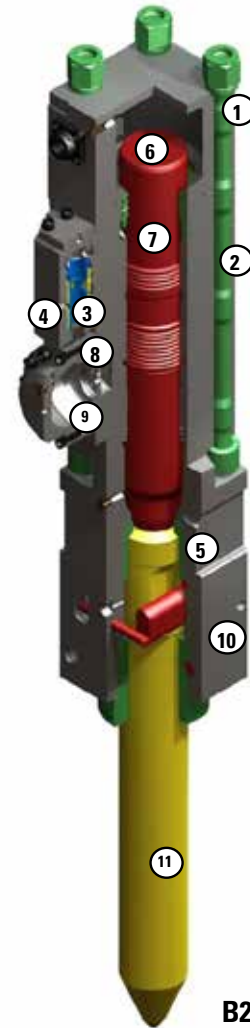

B20, B30, B35

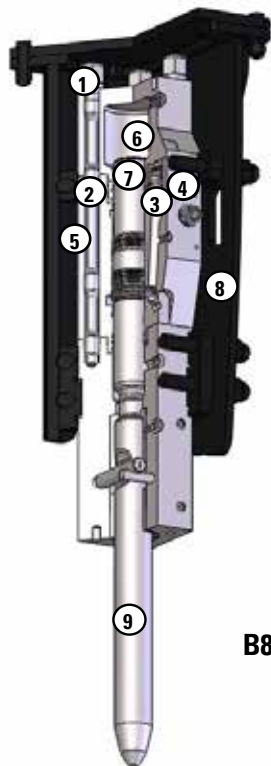

B8

1. SIDE ROD NUT

Thread damage controlled by anti-seize greasing application.

2. SIDE ROD (THROUGH BOLT)

Longer life with high quality material and heat-treatment.

3. PRESSURE CHECK POINT

Easy check-up for hammer operating condition.

4. OIL CONTROL VALVE

Provides reliable performance, and long life-span.

5. MAIN PARTS (Cylinder, Back Head, Front Head, Piston, Tool)

High quality materials and processes used in manufacturing components.

6. BACK HEAD

Bigger N₂ gas chamber. Designed to provide greater power for breaking and absorb piston recoil improving tie rod life.

7. PISTON

Piston provides maximum energy transfer to produce excellent breaking capability. Design and surface finish provides best performance and oil retention resulting in better seal life.

8. HOUSING

Reinforcement plates at bottom. Protects against breakage and wear.

9. TOOLS

Heat treated for longer life. Optimum length for effective breaking.

10. TOP-MOUNT STYLE

Top-mount provides for larger work area and excellent operator visibility.

Applications Tool Selection



Moil (M)



Cone (CO)



Chisel (C)



Blunt (B)

	B8	B20	B30	B35
1. Roadbuilding /construction				
Breaking of road surface (concrete, asphalt)	C, M	C, M, CO	C, M, CO	C, M, CO
Breaking uneven bedrock to lay a road	C, M	C, M, CO	C, M, CO	C, M, CO
Primary Breaking to lay a road	C, M	C, M, CO	C, M, CO	C, M, CO
Asphalt cutting	C			
Trench excavation for drainage	C, M	C, M, CO	C, M, CO	C, M, CO
Demolition of bridges	C, M	B, C, M, CO	B, C, M, CO	B, C, M, CO
Compacting soils	C			
Heavily reinforced bridge pillars	C	C, M, CO	C, M, CO	C, M, CO
Making holes (for traffic signs, lamp posts)	M	CO	CO	CO
Breaking of frozen ground	C, M	C, M, CO	C, M, CO	C, M, CO
2. Demolition / housing development				
Demolition of concrete walls, roofs, floors	C, M	B, C, M, CO	B, C, M, CO	B, C, M, CO
Demolition of light, reinforced concrete foundation (<20")	M	B, M, CO	B, M, CO	B, M, CO
Thick brick walls	C, M	B, C, M, CO	B, C, M, CO	B, C, M, CO
Rock trenches for mains / water supply / utilities	C, M	C, M, CO	C, M, CO	C, M, CO
Rock excavation for foundation		C, M, CO	C, M, CO	C, M, CO
Mass excavation of rock for industrial building bases		C, M, CO	C, M, CO	C, M, CO
Massive reinforced concrete foundations		C, M, CO	C, M, CO	C, M, CO
Separating rebar from concrete (for recycling)	C, M	B, C, M, CO	B, C, M, CO	B, C, M, CO
3. Quarrying / open cast mining				
Secondary breaking of blasted rock		B	B	B
Primary breaking of rock		B, M, C	B, M, C	B, M, C
Breaking oversizes on a crusher/ feeder/ feed chute		B, C, M, CO	B, C, M, CO	B, C, M, CO
Scaling		C, M	C, M	C, M
4. Underground applications				
Trenching in tunnels		C, M, CO	C, M, CO	C, M, CO
5. Metallurgical applications				
Breaking of refractory linings in furnaces	C, M	C, M, CO	C, M, CO	C, M, CO
Breaking of slag in casting ladles		C, M, CO	C, M, CO	C, M, CO
Breaking of slag in converter openings		C, M, CO	C, M, CO	C, M, CO
Cleaning of castings		C, M, CO	C, M, CO	C, M, CO
Breaking of massive steel slag		C, M, CO	C, M, CO	C, M, CO
Breaking of aluminium electrolyze slag			C, M, CO	C, M, CO

Cat B Series Breakers

Specifications		B8	B20	B30	B35
Recommended carrier weight(minimum)	(ton)	6	18	25	30
Recommended carrier weight(maximum)	(ton)	10	25	32	40
Working weight*	(kg)	430**/415***	1680**/1708**	2209 ¹ /2228 ²	3000**
Impact frequency	(BPM)	460-750	400-800	350-700	250-550
Acceptable flow	(L/min)	45-85	125-150	160-190	180-220
Operating Pressure	(Bar)	95-130	160-180	160-180	160-180

* Working weight includes hammer, standard tool and average mounting bracket for top mount style.

** Cannot be used with 320 GC machine

*** 1835 - top-mount weight, 1708 - side mount weight.

¹CB/CB2 Linkage 2209Kg, DB Linkage 2228Kg

Dimension

Top-mount		B8	B20	B30	B35
A. Length	(mm)	460	632	655	730
B. Width	(mm)	346	525	585	635
C. Height(Breaker)	(mm)	877	1634	1829	1995
D. Too Diameter	(mm)	74.5	135	150	153
E. Tool Working Length	(mm)	1487	2389	2632	2798

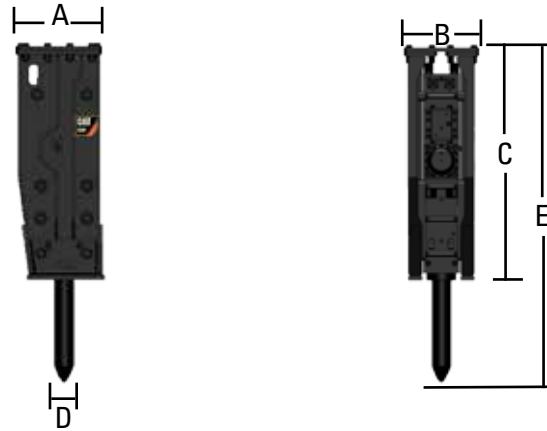

B8 Side mount	Linkage	307&307C&307D
A. Length(Top)	(mm)	772
B. Length (Bottom)	(mm)	351
C. Width	(mm)	304
D. Height(Breaker)	(mm)	848
E. Too Diameter	(mm)	74.5
F. Tool Working Length	(mm)	1485

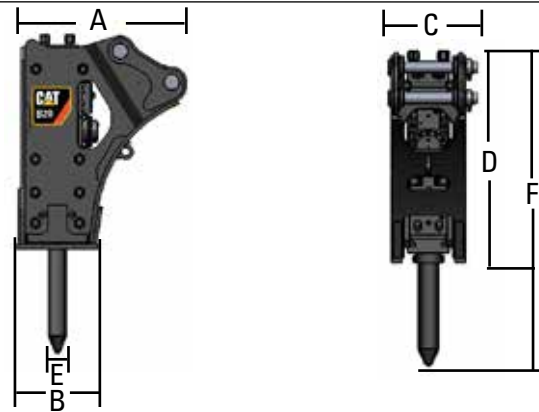

B20 Side mount	Linkage	B/B1	CB/CB2	DB
A. Length(Top)	(mm)	1270	1302	1327
B. Length (Bottom)	(mm)	620	620	620
C. Width	(mm)	457	457	457
D. Height(Breaker)	(mm)	1539	1539	1549
E. Tool Diameter	(mm)	135	135	135
F. Tool Working Length	(mm)	2294	2294	2294

B30 Side mount	Linkage	CB/CB2
A. Length(Top)	(mm)	1366
B. Length (Bottom)	(mm)	650
C. Width	(mm)	524
D. Height(Breaker)	(mm)	1725
E. Tool Diameter	(mm)	150
F. Tool Working Length	(mm)	2603

For more complete information on Cat products, dealer services, and industry solutions, visit us on the web at www.cat.com

©2014 Caterpillar

All Rights Reserved

Materials and specifications are subject to change without notice. Featured machines in photos may include additional equipment. See your Cat dealer for available options.

CAT, CATERPILLAR, their respective logos, "Caterpillar Yellow," and the POWER EDGE trade dress, as well as corporate and product identity used herein, are trademarks of Caterpillar and may not be used without permission.